



POCKET RAMM

How You Do Things



excellence in asset management

CONTENTS

- 1 Start of Day
- 2 Find My Jobs
- 3 Sort Job List
- 4 Add a Job
- 5 Add a Job (Patrol)
- 6 Find Road
- 7 Find Asset
- 8 Add Asset
- 9 Snail Trail and Map Move
- 10 Front or Back Camera
- 11, 12, 13 Icons Explained



Start of the Day

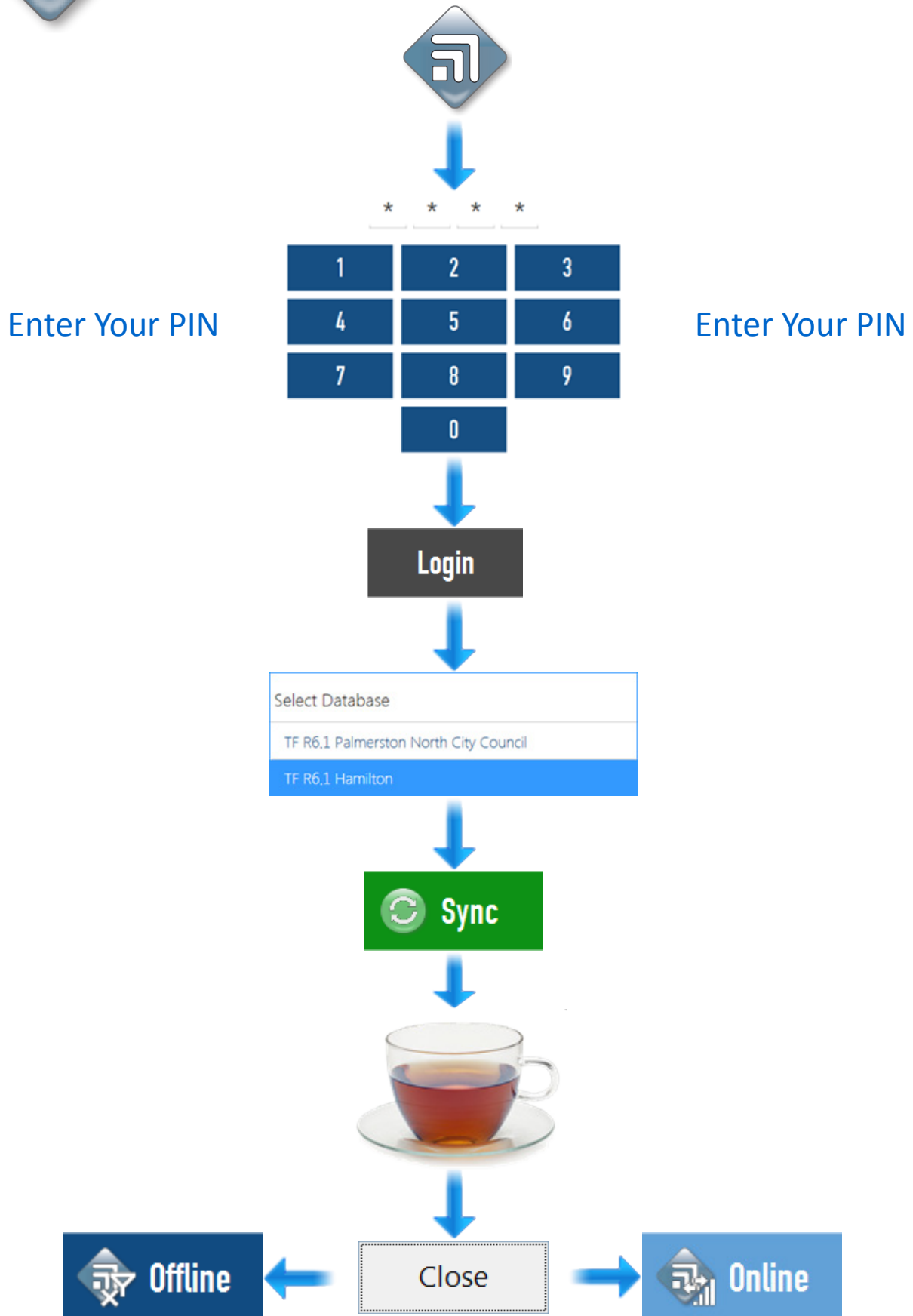

Start of the Day is one in a series of flow charts for Pocket RAMM users



Find My Jobs

Job List



✓	My Open Jobs
---	--------------



Sort Job List

Job List

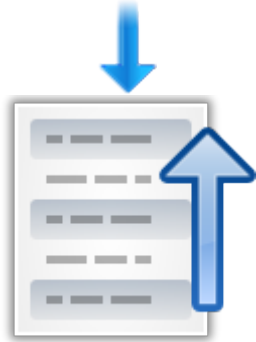

1

Dispatch Id
Dispatch Id Desc
Location
✓ Status
Status Desc
Fault
Fault Desc
Priority
Priority Desc
Asset Type
Entered Date
Completed Date
Suburb
Suburb Desc

2

Dispatch Id
Dispatch Id Desc
Location
Status
Status Desc
Fault
Fault Desc
Priority
Priority Desc
Asset Type
Entered Date
Completed Date
Suburb
Suburb Desc



Add a Job

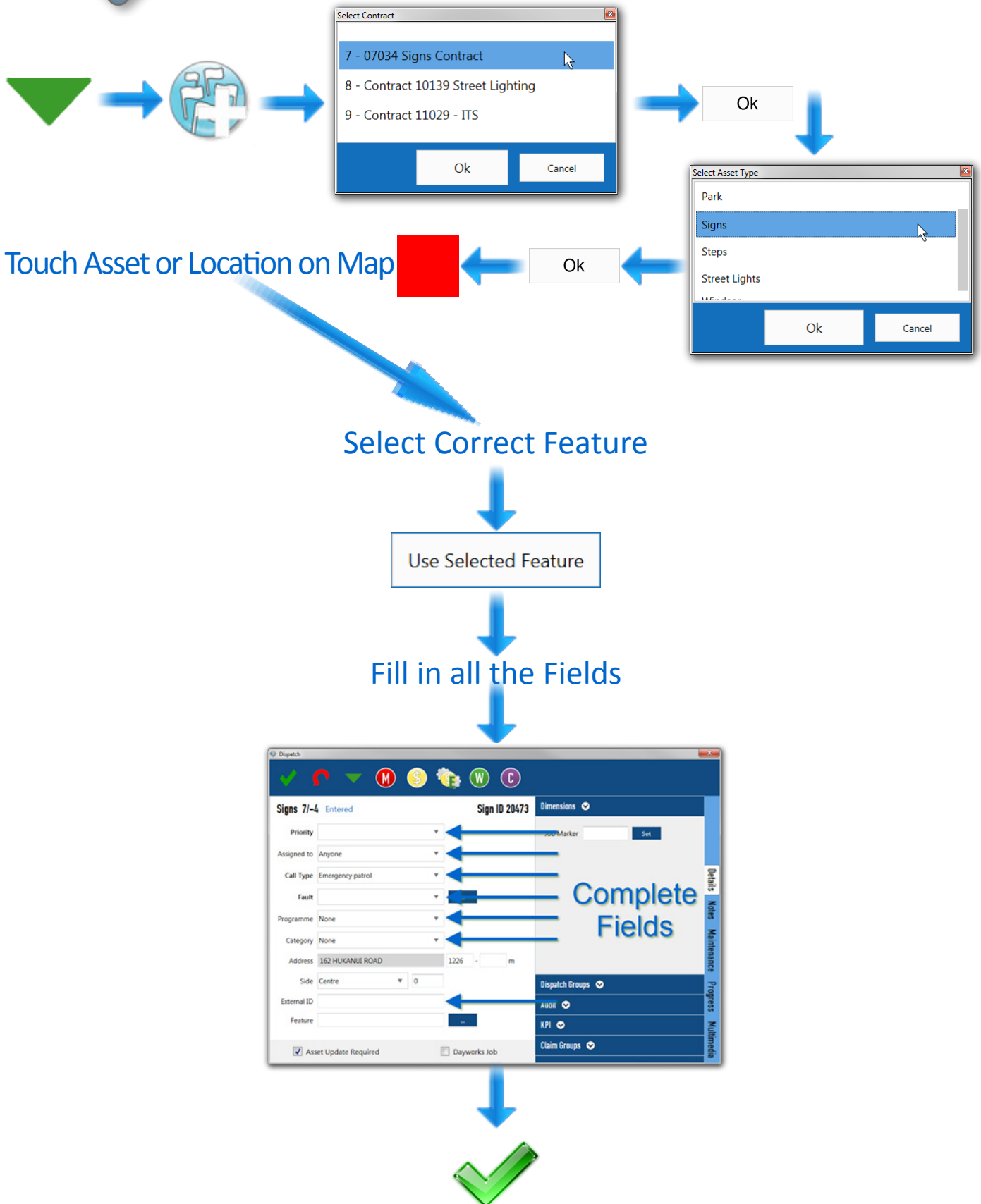

4

Add a Job is one in a series of flow charts for Pocket RAMM users



Add a Job (Patrol)

Press Button for Job



Press Button for Job



Select the Location or Asset for the Job

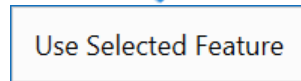

Most Fields in the Job Details Screen Will Have a Default Value



Fill in the Other Fields Such as the Quantity Field



Dispatch

Signs 55/189 Entered Sign ID 48852

Priority Routine

Assigned to Anyone

Call Type Council

Fault Sign - Clean

Programme None

Category None

Address ARRENWAY DRIVE 14 m

Side Centre 1

External ID

Feature

Quantity 0

Units

Job Marker Set

Complete the few fields with no defaulted values

Dispatch Groups

Audit

KPI

Claim Groups

Asset Update Required Dayworks Job





Find Road

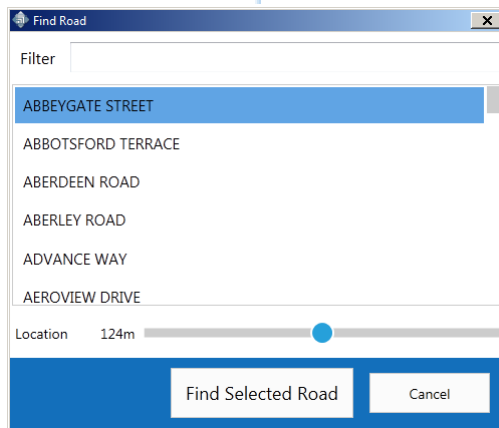

Type Here →

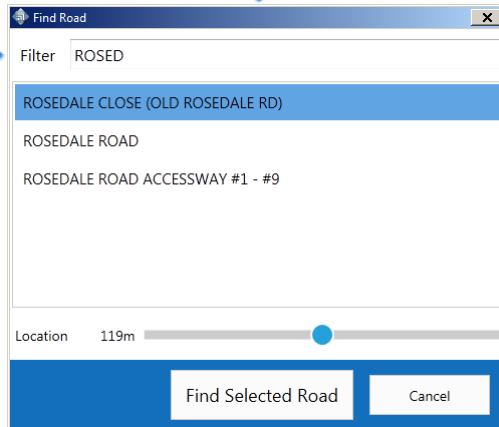

Find Selected Road



Find Asset

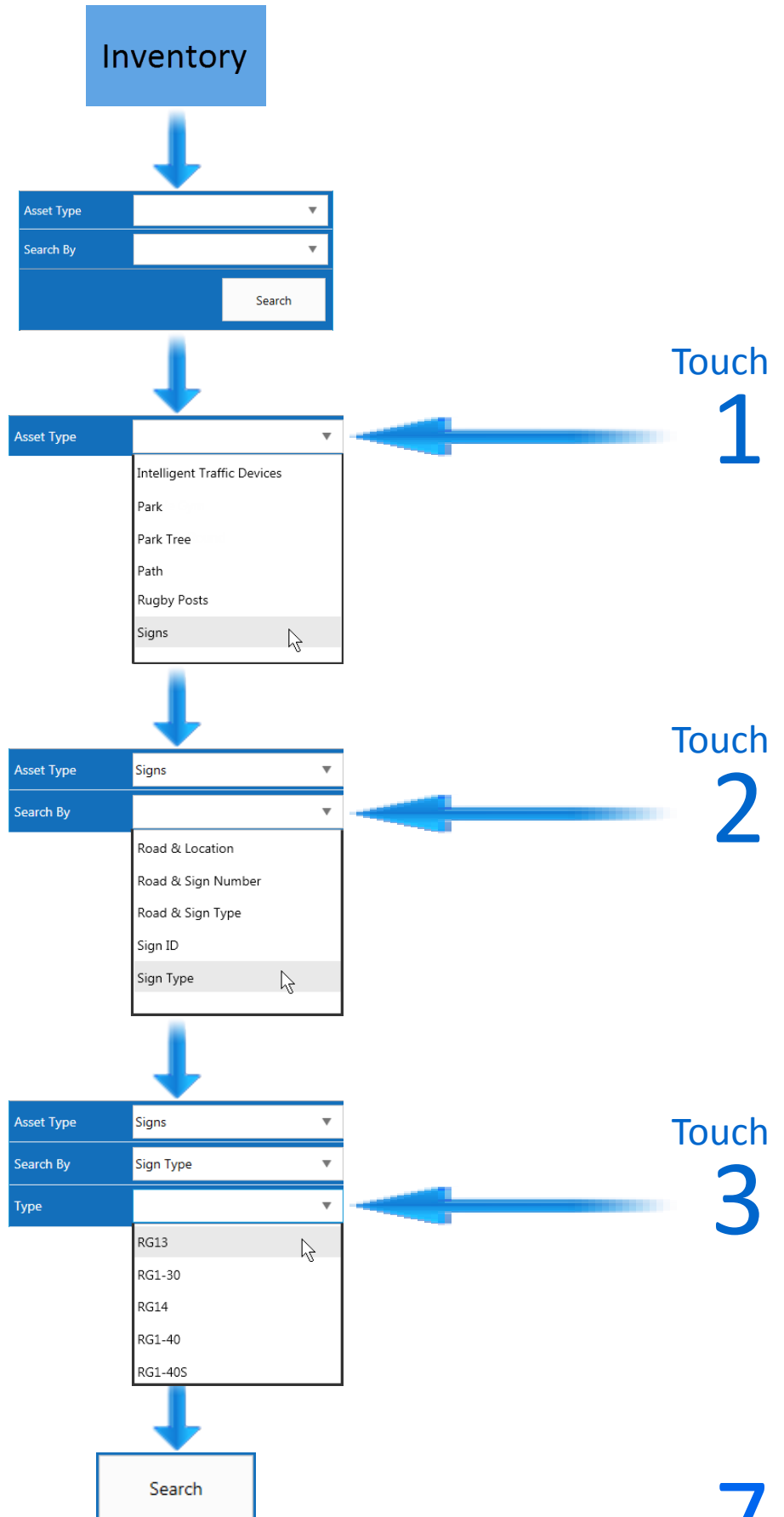

Find Asset is one in a series of flow charts for Pocket RAMM users



Add Asset

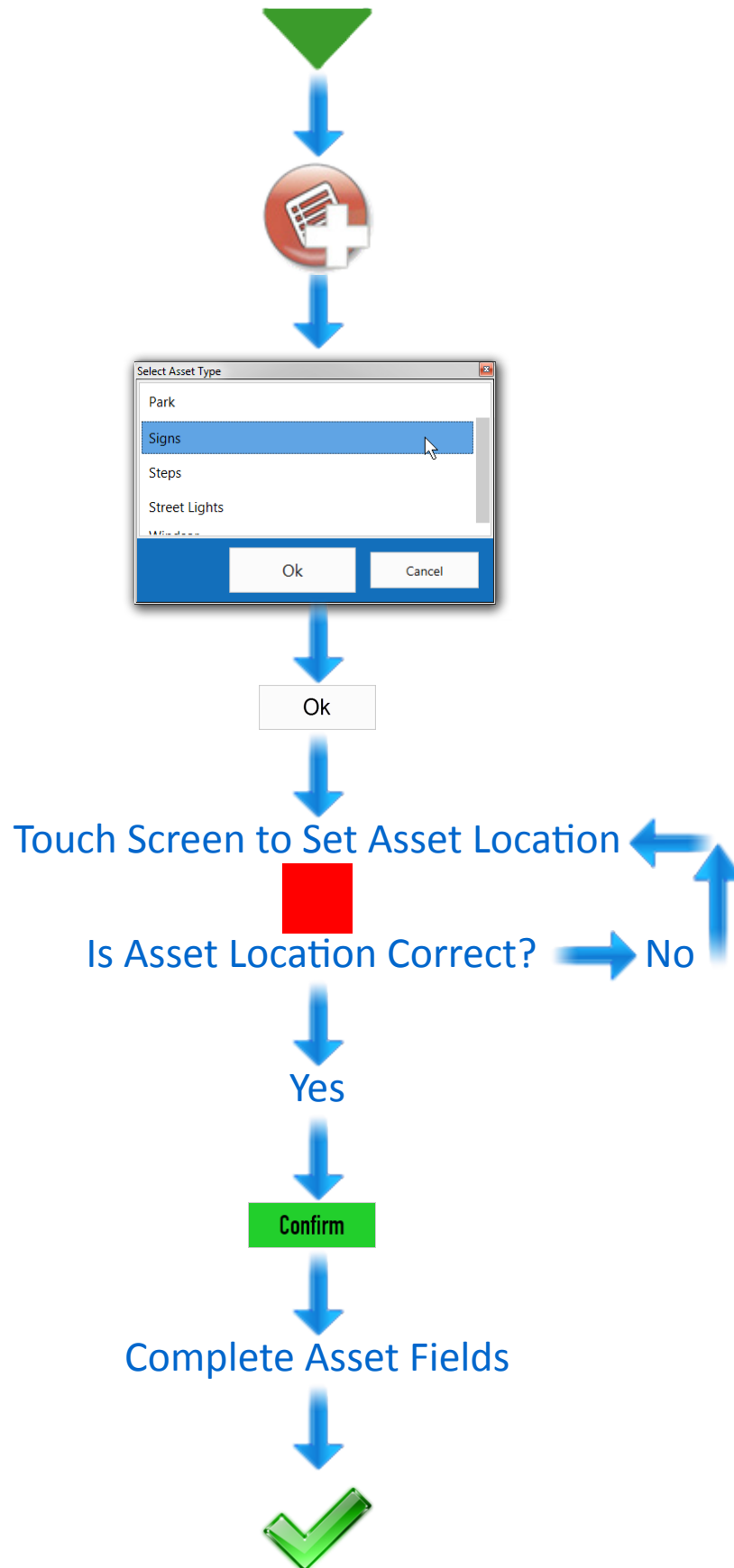



Snail Trail and Map Move

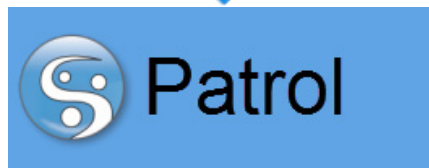

Use map tracking (map moves with GPS)

Show Snail Trail?

Yes

No

Show Snail Trail

Clear Snail Trail





Front + Back Camera

Open Job Details or Open Asset Details

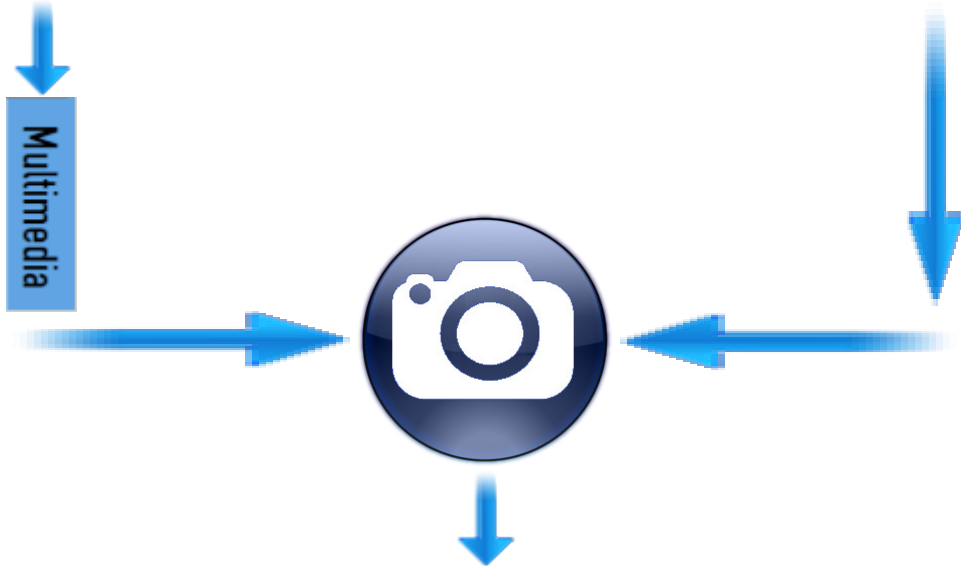











Select Camera

Select Camera

Select Camera













Pocket RAMM Icons 1

- Show Feature Information  Press button and click on feature to view details
- Pan Map  Press button and click on map to centre view
- Zoom In  Press button and click on map to zoom in one level
- Zoom Out  Press button and click on map to zoom out one level
- Move to Current Location  Press button and map centres on where you are
- Show Location  Press button to view your location details
- Zoom to Current Location  Press button and map zooms in to where you are
- Find Road  Press button to open Find Road dialog
- Settings  Press button to adjust your Pocket RAMM settings
- Open Patrol  Press button to select your Patrol



Pocket RAMM Icons 2

- Options**  Press button to show more job and asset options
- Add Job**  Press button to add a job the old way
- Move Feature**  Press button and touch map to move selected item
- Duplicate Feature**  Press button to duplicate selected job or asset
- Add Asset**  Press button to start the process of adding an asset
- Filter**  Press button to view the job list filter options
- Sort**  Press button to select the job list sort criteria
- Apply Filter to Map**  Press button to apply the job list filter to the map
- Search for Job**  Press button to open the Find Job dialog
- Close Patrol**  Press button to close your Patrol



Pocket RAMM Icons 3

Save Changes



Press button to save any changes you have made

Undo Changes



Press button to undo or cancel changes you have made

Synchronise



Press button send and receive database changes made

Change Databases



Press button to change to a different database

Work on Job



Press button to set the time you started on the job

Complete Job



Press button to set the time you finished the job

Add Estimate



Press button to add an estimate line to a job

Automatic Estimating



Press button to default the automatic estimating values

Take Photo



Press button to open the device camera

Add Multimedia



Press button to add multimedia to a folder



excellence in asset management

SUPPORT

FREEPHONE (NZ) 0800 256 832

FREEPHONE (Aus) 1800 196 213

www.ramm.co.nz